

To set up Android for POP, do the following:

1. From the Home screen, tap the Application button.
2. Tap the **Email** icon.
3. If this is your first email account, you will be presented with an email setup screen. Tap the **Next** button. Otherwise, press the **Menu** button, tap **Accounts**, press the **Menu** button, and tap **Add account**.
4. Enter your entire email address (e.g., myname@mydomain.com).
5. In the second box, enter the password associated with your email account.
6. Tap the **Manual setup** button.

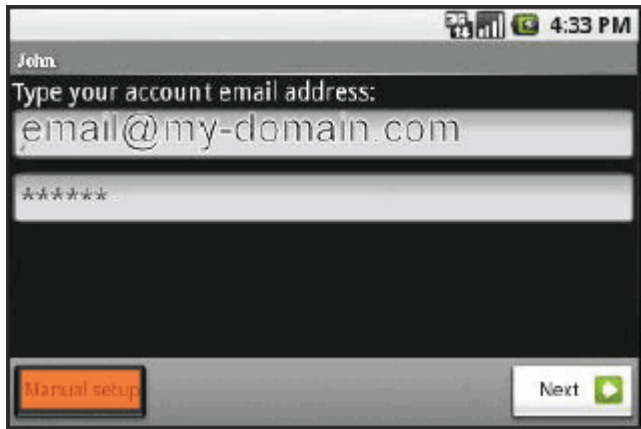

7. Tap the **POP3** button.
8. Enter the following information in the fields provided:
 - Username—Enter your entire email address (e.g., myname@mydomain.com).
 - Password—Enter the password associated with your email account.
 - POP server—Enter the secure server name:
secure.emailsrvr.com
 - Port—Enter the secure port number: **995**
 - Security type—Select **SSL**.

Note: Be sure the **Port** number is still **995**.
9. Tap the **Next** button. The device will connect to the internet and check your incoming settings.
10. On the **Outgoing server settings** screen, enter the following information in the fields provided:
 - SMTP server—Enter the secure server name:
secure.emailsrvr.com
 - Port—Enter the secure port number: **465**
 - Security type—Select **SSL**.

Note: Be sure the **Port** number is still **465**.
11. Tap the **Require sign-in** checkbox.
12. Tap the **Next** button. The device will connect to the internet and check your outgoing settings.

13. On the **Account options** screen, make changes, as desired.

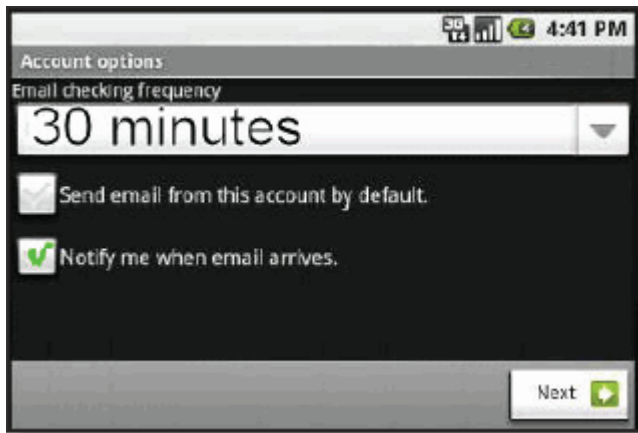

14. Tap the **Next** button. On the **Set up email** screen, enter your name in the **Your name** field. This is the name that will be displayed in the **From** field of email messages you send.

15. Tap the **Done** button.